



# FOREST HOME WALKWAY IMPROVEMENTS CONTRACT DRAWINGS

TOWN OF ITHACA, TOMPKINS COUNTY, NEW YORK

## DRAWING INDEX

| SHEET NO. | DRAWING NO. | TITLE                       |
|-----------|-------------|-----------------------------|
| 1         | COV         | TITLE SHEET                 |
| 2         | GN-1        | GENERAL NOTES               |
| 3         | TS-1        | TYPICAL SECTIONS - 1        |
| 4         | TS-2        | TYPICAL SECTIONS - 2        |
| 5         | KM-1        | SITE LAYOUT PLAN - KEY PLAN |
| 6         | PL-1        | SITE LAYOUT PLAN - 1        |
| 7         | PL-2        | SITE LAYOUT PLAN - 2        |
| 8         | PL-3        | SITE LAYOUT PLAN - 3        |
| 9         | PRO-1       | WALKWAY PROFILE             |
| 10        | MD-1        | MISCELLANEOUS DETAILS       |
| 11        | MD-2        | MISCELLANEOUS DETAILS       |
| 12        | MD-3        | MISCELLANEOUS DETAILS       |
| 13        | MD-4        | MISCELLANEOUS DETAILS       |

ROD HOWE - TOWN SUPERVISOR  
BILL GOODMAN - DEPUTY TOWN SUPERVISOR  
RICH DEPAOLO - TOWN BOARD MEMBER  
PAMELA BLEIWAS - TOWN BOARD MEMBER  
TEE-ANN HUNTER - TOWN BOARD MEMBER  
PAT LEARY - TOWN BOARD MEMBER  
ERIC LEVINE - TOWN BOARD MEMBER

APRIL 2021

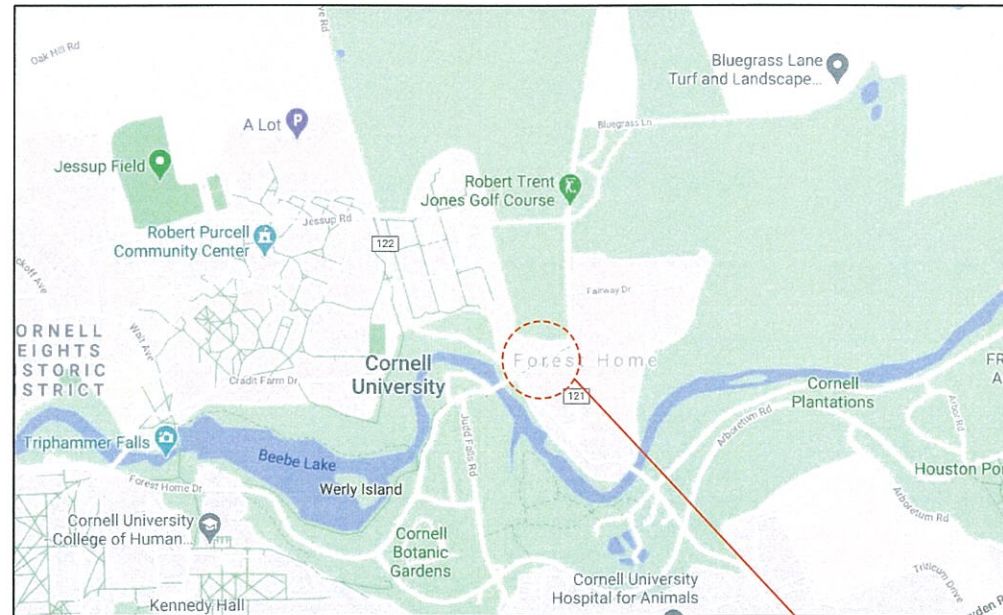

PROJECT LOCATION

PROJECT  
LOCATION

## STANDARD SHEETS

THE LATEST REVISIONS OF THE STANDARD SHEETS MAINTAINED BY THE NYS DEPARTMENT OF TRANSPORTATION, WHICH ARE CURRENT ON THE DATE OF ADVERTISEMENT FOR BIDS, SHALL BE CONSIDERED TO BE IN EFFECT. ALL PAY ITEMS AND WORK CONTAINED IN THE CONTRACT AND ANY ADDITIONAL PAY ITEMS AND WORK ENCOUNTERED DURING THE COURSE OF THE CONTRACT SHALL BE SUBJECT TO THE APPLICABLE STANDARD SHEET(S) UNLESS OTHERWISE SPECIFIED IN THE CONTRACT DOCUMENTS.

ALL WORK CONTEMPLATED UNDER THIS CONTRACT IS TO BE COVERED BY AND IN CONFORMITY WITH THE STANDARD SPECIFICATIONS (US CUSTOMARY/METRIC) REFERENCED IN THE CONTRACT PROJECT "PROPOSAL" EXCEPT AS MODIFIED BY THESE PLANS OR BY CHANGES SET FORTH IN THE CONTRACT PROJECT "PROPOSAL".

IT IS A VIOLATION OF LAW FOR ANY PERSON, UNLESS THEY ARE ACTING UNDER THE DIRECTION OF A LICENSED PROFESSIONAL ENGINEER, ARCHITECT, LANDSCAPE ARCHITECT, OR LAND SURVEYOR, TO ALTER AN ITEM IN ANY WAY. IF AN ITEM BEARING THE STAMP OF A LICENSED PROFESSIONAL IS ALTERED, THE ALTERING ENGINEER, ARCHITECT, LANDSCAPE ARCHITECT, OR LAND SURVEYOR SHALL STAMP THE DOCUMENT AND INCLUDE THE NOTATION "ALTERED BY" FOLLOWED BY THEIR SIGNATURE, THE DATE OF SUCH ALTERATION, AND A SPECIFIC DESCRIPTION OF THE ALTERATION.

RECOMMENDED BY

ROD HOWE  
TOWN SUPERVISOR

DATE

Barton  
&Loguidice

PREPARED AND RECOMMENDED BY



CHARLES A. WHITE, P.E.  
NEW YORK STATE PROFESSIONAL ENGINEERS LICENSE NO. 081958

3/29/2021

DATE



GENERAL NOTES:

- ALL DIMENSIONS SHALL BE FIELD MEASURED AND VERIFIED PRIOR TO COMMENCING ANY WORK.
- CLEARING AND GRUBBING OF ALL TREES, SHRUBS, VEGETATION, AND STUMPS IS TO BE PERFORMED BY THE TOWN PRIOR TO CONSTRUCTION. THE TOWN'S REPRESENTATIVE SHALL VERIFY ANY AND ALL ADDITIONAL REMOVALS PRIOR TO THE CONTRACTOR COMPLETING THE WORK. PAYMENT FOR CLEARING AND GRUBBING SHALL BE INCLUDED UNDER THE RESPECTIVE BID ITEM.
- THE CONTRACTOR SHALL PROTECT THE EXISTING TREES AND SHRUBS AGAINST CUTTING, BREAKING, SKINNING OF ROOTS, BREAKING BARK, SMOTHERING ROOTS WITH STOCKPILED MATERIALS OR COMPACTION OF SOIL BY EXCESS VEHICULAR TRAFFIC WITHIN THE DRIP LINE UNLESS THE VEGETATION IS SHOWN TO BE REMOVED. CONTRACTOR MAY NEED TO PROVIDE TREE AND VEGETATION BARRIER AROUND THE DRIP LINE OF TREES IF NEEDED. AS DIRECTED BY THE TOWN'S REPRESENTATIVE, COST OF THIS WORK SHALL BE INCLUDED UNDER THE RESPECTIVE BID ITEM.
- THE CONTRACTOR SHALL PERFORM ALL WORK WITH CARE SO THAT ANY MATERIALS WHICH ARE TO REMAIN IN PLACE WILL NOT BE DAMAGED. IF THE CONTRACTOR DAMAGES ANY MATERIALS WHICH ARE TO REMAIN IN PLACE, THE DAMAGED MATERIALS SHALL BE REPAIRED OR REPLACED IN A MANNER SATISFACTORY TO THE TOWN'S REPRESENTATIVE AT THE EXPENSE OF THE CONTRACTOR.
- WHENEVER ITEMS IN THE CONTRACT REQUIRE MATERIALS TO BE REMOVED AND DISPOSED OF, THE COST OF SUPPLYING A DISPOSAL AREA AND TRANSPORTATION TO THAT AREA SHALL BE INCLUDED UNDER THE VARIOUS BID ITEMS IN THE CONTRACT.
- THE CONTRACTOR SHALL BECOME ACQUAINTED WITH THE DRAINAGE CHARACTERISTICS OF THE AREA IN ORDER TO PROGRESS WORK EFFICIENTLY WITH FULL KNOWLEDGE OF THE POTENTIAL DRAINAGE PROBLEMS.
- ALL EXISTING DRAINAGE SYSTEMS, INCLUDING DITCHES AND CULVERTS, WITHIN THE CONTRACT LIMITS SHALL BE KEPT CLEAN AND FREE FLOWING FOR THE DURATION OF THE CONTRACT. PAYMENT FOR ANY NECESSARY CLEANING, AS DIRECTED BY THE TOWN'S REPRESENTATIVE, SHALL BE INCLUDED UNDER THE RESPECTIVE BID ITEM.
- THE WALKWAY SHALL BE CLOSED TO THE PUBLIC DURING CONSTRUCTION. THE CONTRACTOR SHALL BE RESPONSIBLE FOR INSTALLING AND MAINTAINING ALL APPROPRIATE SIGNAGE AND/OR BARRIERS.

SPECIFICATIONS:

- THE CONTRACTOR SHALL FOLLOW THE PROVISIONS OF THE NYSDOT STANDARD SPECIFICATIONS (US CUSTOMARY) REFERENCED IN THE CONTRACT EXCEPT AS MODIFIED BY THESE PLANS OR BY CHANGES SET FORTH IN THE CONTRACT. THESE PLANS ARE SUBMITTED IN ACCORDANCE WITH THE HIGHWAY LAW AND THE LATEST STANDARD SPECIFICATIONS OFFICIALLY FINALIZED AND ADOPTED AS POSTED ON THE DEPARTMENT'S WEBSITE.
- REFER TO THE SPECIAL NOTES SECTION IN THE CONTRACT SPECIFICATIONS FOR ALL WORK TO BE COMPLETED UNDER THE PROPOSED ITEM OF "LANDSCAPE RESTORATION" AS INDICATED IN THESE CONTRACT PLANS.

UTILITIES:

- THE APPROXIMATE LOCATION OF THE UTILITIES ARE SHOWN ON THE PLANS. THE CONTRACTOR SHALL VERIFY THE TRUE LOCATION BEFORE COMMENCING WORK.
- THE CONTRACTOR SHALL BE RESPONSIBLE FOR THE PROTECTION OF ALL UTILITIES ENCOUNTERED IN THIS WORK. WHERE NECESSARY, THE CONTRACTOR SHALL PROVIDE TIMBER, OR OTHER APPROVED MATERIALS AND SECURELY BRACE AND PROTECT THESE UTILITIES. THE COST OF THIS WORK SHALL BE INCLUDED IN THE PRICE BID FOR VARIOUS ITEMS IN THE CONTRACT.
- ALL WORK SHALL BE IN COMPLIANCE WITH STANDARD SPECIFICATION SECTION 107-07.

WORK ZONE TRAFFIC CONTROL NOTES:

- PRIOR TO THE START OF ANY WORK OPERATIONS, ALL RELATED WORK FOR PROPOSED MAINTENANCE AND PROTECTION OF TRAFFIC, AS DETERMINED BY THE TOWNS REPRESENTATIVE AND/OR LOCAL GOVERNING AUTHORITY, SHALL BE COMPLETE. THIS INCLUDES, BUT IS NOT LIMITED TO, ALL SIGNS, PAVEMENT MARKINGS, BARRIERS, DELINEATION (TUBULAR MARKERS, DRUMS, ETC.), FLAGGERS, PAVEMENT MODIFICATIONS, AND ANY OTHER RELATED WORK.
- THE CONTRACTOR SHALL SCHEDULE WORK SO THAT ALL TRAVEL LANES IN EACH DIRECTION ARE OPEN WHEN THE CONTRACTOR'S OPERATIONS ARE CLOSED DOWN OR SUBSTANTIALLY CLOSED DOWN.
- WHERE POSSIBLE ALL CHANNELIZING/DELINEATION DEVICES ARE TO BE PLACED SO AS TO PROVIDE A MINIMUM OF 2 FEET CLEARANCE TO THE TRAVELED WAY. THE CONTRACTOR SHALL MAKE CERTAIN THAT PLACEMENT OF CONES, DRUMS AND MARKERS, OR BARRICADES SHALL NOT INTERFERE WITH SIGHT DISTANCE.
- COLORS USED FOR CONSTRUCTION SIGNING (INCLUDING TEMPORARY OR MODIFIED GUIDE SIGNS) SHALL BE BLACK LEGEND ON ORANGE BACKGROUND.
- ALL SIGNS NECESSARY FOR THE MAINTENANCE AND PROTECTION OF TRAFFIC (INCLUDING RELOCATION AND/OR MODIFICATION AND/OR RESTORATION OF EXISTING SIGN PANELS) AS NOTED IN THE PLANS, 2009 NATIONAL MANUAL ON UNIFORM TRAFFIC CONTROL DEVICES (MUTCD), MOST RECENT NYS SUPPLEMENT TO THE NATIONAL MUTCD AND NYSDOT STANDARD SPECIFICATION - SECTION 619 WORK ZONE TRAFFIC CONTROL, OR AS DIRECTED BY THE TOWNS REPRESENTATIVE AND/OR LOCAL GOVERNING AUTHORITY SHALL BE INCLUDED UNDER VARIOUS ITEMS IN THE CONTRACT.
- THE CONTRACTOR SHALL PROVIDE AND MAINTAIN AT ALL TIMES A SAFE AND ADEQUATE INGRESS AND EGRESS TO AND FROM ALL PRIVATE RESIDENCES ADJACENT TO THE PROJECT SITE. COST FOR THIS WORK SHALL BE INCLUDED UNDER THE RESPECTIVE BID ITEM.

SITE ACCESS

- CONTRACTOR SHALL USE RUBBER TRACK OR TIRE EQUIPMENT TO ACCESS SITE FROM WARREN ROAD AND MUST NOT DISTURB SOILS OUTSIDE AREA OF DISTURBANCE.
- CONTRACTOR SHALL MAINTAIN A CLEAN WORK SITE AT ALL TIMES. AT THE END OF THE WORK DAY ALL EQUIPMENT AND MATERIALS SHALL BE STORED IN A DESIGNATED STAGING AREA AS COORDINATED WITH THE TOWN. ALL SOIL, DUST AND MUD SHALL BE REMOVED FROM THE PROJECT AREA AND OUTSIDE THE PROJECT AREA. AT THE END OF THE DAY, TIRES OF CONSTRUCTION VEHICLES SHALL BE CLEANED OF SOIL AND MUD BEFORE BEING ALLOWED ON PUBLIC STREETS. ANY SOIL OR MUD DEPOSITED ON PUBLIC STREETS BY CONSTRUCTION VEHICLES SHALL BE REMOVED IMMEDIATELY.
- ALL EQUIPMENT ENTERING AND LEAVING THE SITE SHALL BE COVERED BY LAW TO REDUCE DUST AND ODOR.
- CONTRACTOR SHALL VERIFY THAT STAGING AREA AND EQUIPMENT WASHOUTS DO NOT REQUIRE ANY TREE REMOVAL.
- THERE ARE NO LOCATIONS AVAILABLE ON SITE TO STORE MATERIALS AND/OR EQUIPMENT. CONTRACTOR SHALL BE RESPONSIBLE TO COORDINATE ALL MATERIAL AND/OR EQUIPMENT STORAGE AREAS ON OR OFFSITE.
- THE CONTRACTOR SHALL AT THEIR OWN EXPENSE, RESTORE LAWNS, DRIVEWAYS, CULVERTS, FENCES, GUIDERAILS, SIGNS AND OTHER PUBLIC AND PRIVATE PROPERTY DAMAGED OR REMOVED TO AT LEAST AS GOOD A CONDITION AS BEFORE BEING DISRUPTED.

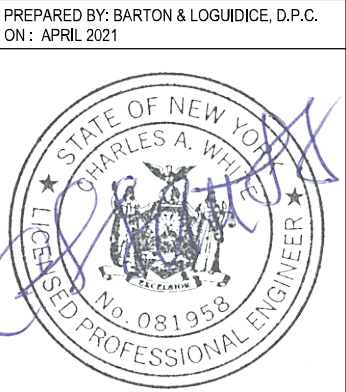

EROSION AND SEDIMENT CONTROL NOTES:

- ANY PROPOSED CHANGES TO THE EROSION AND SEDIMENT CONTROL MEASURES SHALL BE APPROVED BY THE TOWN'S REPRESENTATIVE PRIOR TO BEING IMPLEMENTED.
- THE CONTRACTOR IS ADVISED THAT THE LOCATIONS OF THE TEMPORARY DEVICES ARE APPROXIMATE. THE EXACT DEVICE LOCATIONS TO ACCOMMODATE THE PROPOSED WORK SHALL BE THE CONTRACTOR'S RESPONSIBILITY.
- THE CONTRACTOR'S ATTENTION IS DIRECTED TO THE FACT THAT THROUGHOUT THE DURATION OF THE CONTRACT, IT WILL BE THE CONTRACTOR'S RESPONSIBILITY TO PROTECT ALL WATER COURSES FROM SEDIMENT OR POLLUTANTS ORIGINATING FROM ANY WORK BEING DONE ON OR IN SUPPORT OF THIS PROJECT.
- THE EROSION AND SEDIMENT CONTROL NOTES AND DETAILS SHOWN IN THESE DRAWINGS ARE NOT INTENDED TO BE ALL INCLUSIVE BUT TO SERVE AS A GUIDELINE FOR THE DEVELOPMENT OF THE CONTRACTOR'S EROSION CONTROL SCHEME REQUIRED UNDER THE RESPECTIVE ITEMS FOR THE CONTRACT.
- THE CONTRACTOR SHALL INSPECT THE SOIL EROSION PREVENTION AND SEDIMENT CONTROL MEASURES ON A WEEKLY BASIS OR AS REQUIRED BY THE TOWN'S REPRESENTATIVE. REPAIRS SHALL BE MADE BY THE CONTRACTOR AS NEEDED WITHIN 3 CALENDAR DAYS, AND SEDIMENT SHALL BE REMOVED BY THE CONTRACTOR WHEN THE STORAGE VOLUME OF AN EROSION CONTROL MEASURE IS APPROACHING ONE-HALF OF ITS INTENDED CAPACITY OR AS REQUIRED BY THE TOWN'S REPRESENTATIVE. FAILURE TO COMPLY WITH THIS PROVISION IS BASIS TO SHUT DOWN THE PROJECT, AT NO EXPENSE TO THE TOWN.
- ALL NECESSARY PRECAUTIONS SHALL BE TAKEN TO PREVENT CONTAMINATION OF ANY STREAMS, CHANNELS, OR WATERWAYS BY SILT, SEDIMENTS, FUEL SOLVENTS, LUBRICANTS, EPOXY COATINGS, DEBRIS, CONCRETE LEACHATE OR ANY OTHER POLLUTANT ASSOCIATED WITH CONSTRUCTION AND CONSTRUCTION PROCEDURES. DURING CONSTRUCTION, NO WET OR FRESH CONCRETE OR LEACHATE SHALL BE ALLOWED TO ESCAPE INTO THE WATERS OF THE UNITED STATES. EQUIPMENT, TOOLS, TRUCKS AND OTHER DEVICES USED IN THIS PROJECT SHALL BE CLEANED IN SUCH A MANNER AS TO PREVENT WASH WATER FROM ENTERING ANY WATER BODY OR WETLAND. WASHOUT BASINS MUST BE USED.
- ALL DISTURBED AREAS WILL BE STABILIZED IN ACCORDANCE WITH THE PLANS AND DETAILS IN THE CONTRACT DOCUMENTS.
- ALL EXCAVATED MATERIAL SHALL BE DISPOSED OF ON AN UPLAND SITE AND BE SUITABLY STABILIZED SO THAT IT CANNOT REASONABLY RE-ENTER ANY BODY OF WATER.
- ALL EROSION AND SEDIMENT CONTROLS SHALL BE PLACED PRIOR TO STARTING EARTHWORK OPERATIONS AND SHALL REMAIN IN PLACE UNTIL THE NEW SLOPES ARE STABILIZED WITH SEEDING AND/OR SLOPE PROTECTION, AND A.O.B.E. STABILIZATION WILL BE CONSIDERED AS 80% COVER, PER SQUARE FOOT, ACROSS THE SITE.
- THE COST OF INSTALLING, CLEANING, AND REMOVING TEMPORARY SOIL EROSION AND SEDIMENT CONTROL DEVICES SHALL BE INCLUDED UNDER VARIOUS ITEMS IN THE CONTRACT DOCUMENTS.
- CONTRACTOR SHALL PROTECT ALL VEGETATION OUTSIDE THE LIMITS OF CONSTRUCTION AND MINIMIZE DISTURBANCE TO VEGETATION WITHIN THE LIMITS OF CONSTRUCTION.
- ALL AREAS OF SOIL DISTURBANCES RESULTING FROM THIS PROJECT SHALL BE SEEDED WITH AN APPROPRIATE PERENNIAL GRASS SEED AND MULCHED WITH STRAW WITHIN ONE WEEK OF FINAL GRADING. MULCH SHALL BE MAINTAINED UNTIL 80% GROWTH HAS BEEN ESTABLISHED.
- RESTORE ALL SURFACES TO AS GOOD AS OR BETTER CONDITION THAN BEFORE CONSTRUCTION AS SOON AS POSSIBLE FOLLOWING COMPLETION OF WORK IN ANY AREA.
- THE CONTRACTOR SHALL FURNISH AND APPLY WATER FOR DUST CONTROL, AS NEEDED. NO SEPARATE PAYMENT FOR DUST CONTROL SHALL BE MADE.
- CARE SHALL BE TAKEN TO RETAIN VEGETATION AND PREVENT DAMAGE TO TREES & ORNAMENTAL PLANT MATERIAL WITHIN AND OUTSIDE THE LIMITS OF CONSTRUCTION, AND NOT SCHEDULED FOR REMOVAL. ANY DAMAGE CAUSED TO THIS VEGETATION SHALL BE RESTORED AT THE EXPENSE OF THE CONTRACTOR AS DIRECTED BY THE TOWN'S REPRESENTATIVE.
- UNDER NO CONDITION, SHALL ANY AREA OF UNPROTECTED ERODIBLE EARTH MATERIAL EXPOSED BY CLEARING AND GRUBBING, EXCAVATION, BORROW, OR FILL BE LEFT IN AN UNPROTECTED CONDITION. ANY PORTION OF AN AREA ON WHICH CLEARING AND GRUBBING, EXCAVATION, BORROW, OR FILL HAD PERMANENTLY CEASED SHALL BE STABILIZED, BY EITHER TEMPORARY OR PERMANENT MEANS. THE CONTRACTOR WILL ALSO BE AWARE OF IMPENDING WEATHER CONDITIONS AND THE NEED TO APPLY RECP MULCH ON AREAS THAT WORK IS PROGRESSING.
- MAINTENANCE OF TEMPORARY SEEDED AREAS SHALL INCLUDE RE-SEEDING AS NEEDED (OR AOB) TO ESTABLISH A SATISFACTORY STAND OF TURF. THE COST OF RESEEDING SHALL BE AT THE CONTRACTORS EXPENSE. IT IS HIGHLY RECOMMENDED THAT THE SEEDING BE DONE PRIOR TO INSTALLING THE RECP.
- ALL SEED MUST BE PRE-APPROVED BY THE TOWN'S REPRESENTATIVE PRIOR TO SEEDING OPERATIONS.
- ALL SLOPES SHALL BE BROUGHT TO FINISHED GRADE AND TRIMMED AS SOON AS POSSIBLE. ALL SLOPES 3:1 OR GREATER SHALL BE STABILIZED IN ACCORDANCE WITH DETAIL 4/MD-1.
- PERMANENT EROSION CONTROL MEASURES OF SEEDING AND MULCHING (SEED ONLY WITHIN SEEDING DATES) SHALL BE CARRIED OUT ONCE THE SLOPES HAVE REACHED FINAL GRADE. TEMPORARY EROSION AND SEDIMENT CONTROL MEASURES AS SHOWN IN THE TEMPORARY SLOPE TREATMENT TABLE SHALL BE EMPLOYED AS INDICATED.

|  |  |    |  |          |   |                            |
|--|--|----|--|----------|---|----------------------------|
| NO. DATE   |  | BY |  | REVISION |   | <div>2</div> <div>13</div> |
|  |  |    |  |          |   |                            |
|  |  |    |  |          |   |                            |
| <div>Barton &amp; Loguidice</div>                |  |    |  |          | UNAUTHORIZED ALTERATION OR ADDITION TO THIS DRAWING IS A VIOLATION OF THE NEW YORK STATE EDUCATION LAW, ARTICLE 145, SECTION 7209 |                            |
| FOREST HOME WALKWAY IMPROVEMENTS<br>FINAL DESIGN |  |    |  |          |   |                            |
| TOWN OF ITHACA                                   |  |    |  |          |   |                            |
| TOMPKINS COUNTY                                  |  |    |  |          |   |                            |
| GENERAL NOTES                                    |  |    |  |          |   |                            |
| SCALE: AS SHOWN                                  |  |    |  |          |   |                            |
| DATE ISSUED: 04/2021                             |  |    |  |          |   |                            |
| DRAWING<br>GN-1                                  |  |    |  |          |   |                            |

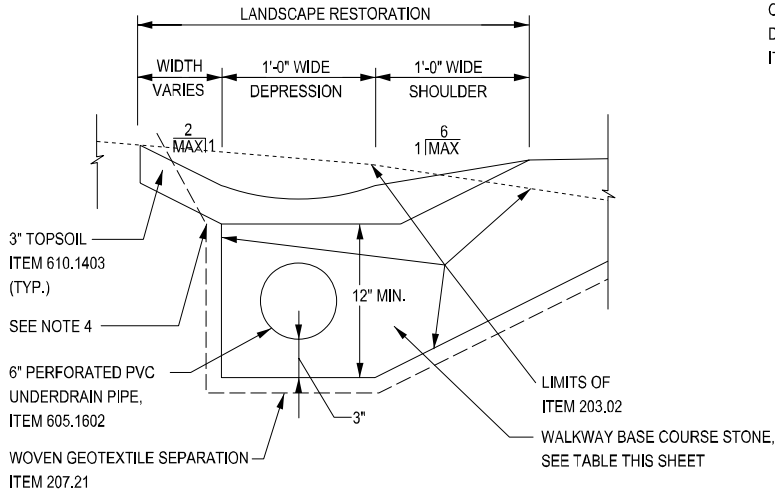

FRENCH DRAIN DETAIL  
NOT TO SCALE  
LOCATIONS:  
STA. 10+43.70 LT TO STA. 11+54.50 LT

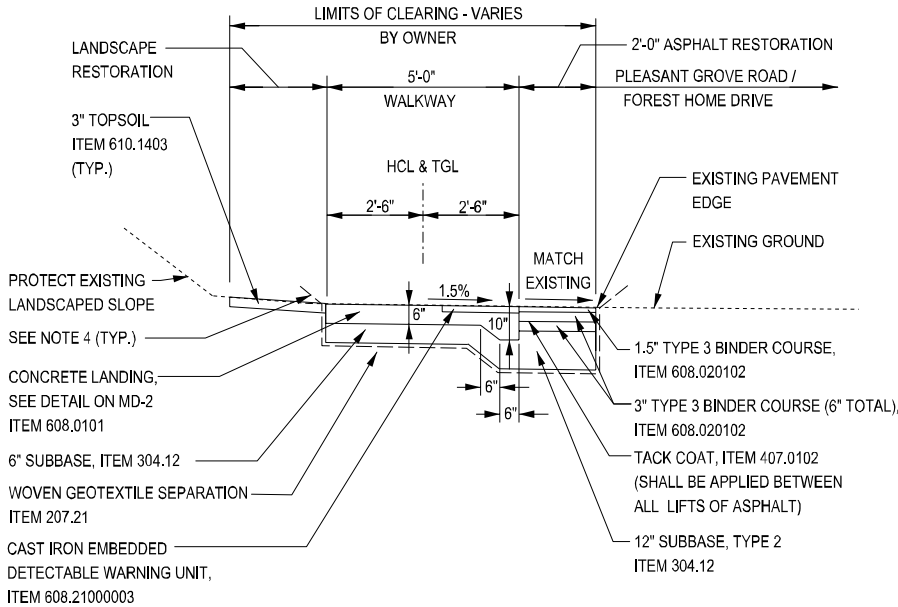

TYPICAL SECTION NO. 1A  
NOT TO SCALE  
LOCATIONS:  
STA. 10+00.00 TO STA. 10+05.00

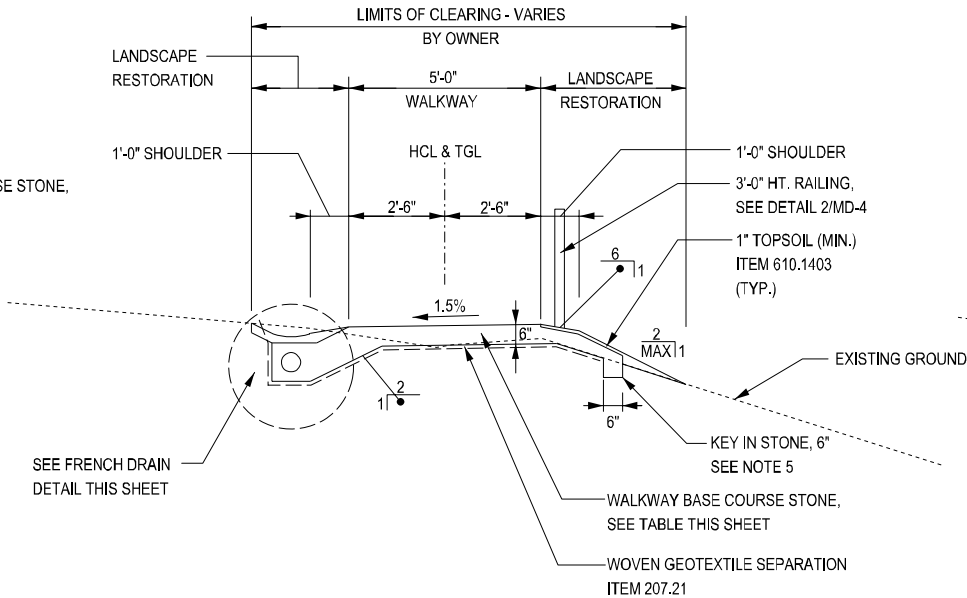

TYPICAL SECTION NO. 2  
NOT TO SCALE  
LOCATIONS:  
STA. 10+50.00 TO STA. 11+54.50

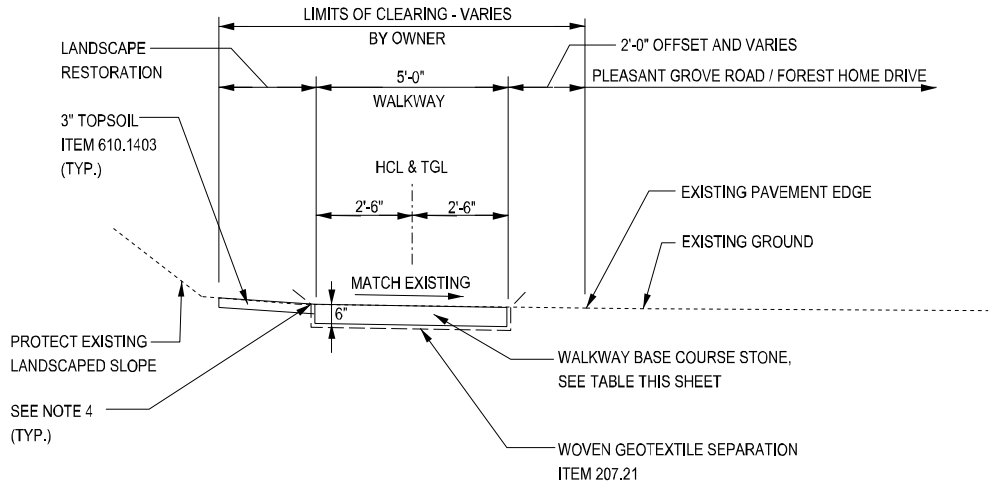

TYPICAL SECTION NO. 1  
NOT TO SCALE  
LOCATIONS:  
STA. 10+05.00 TO STA. 10+50.00

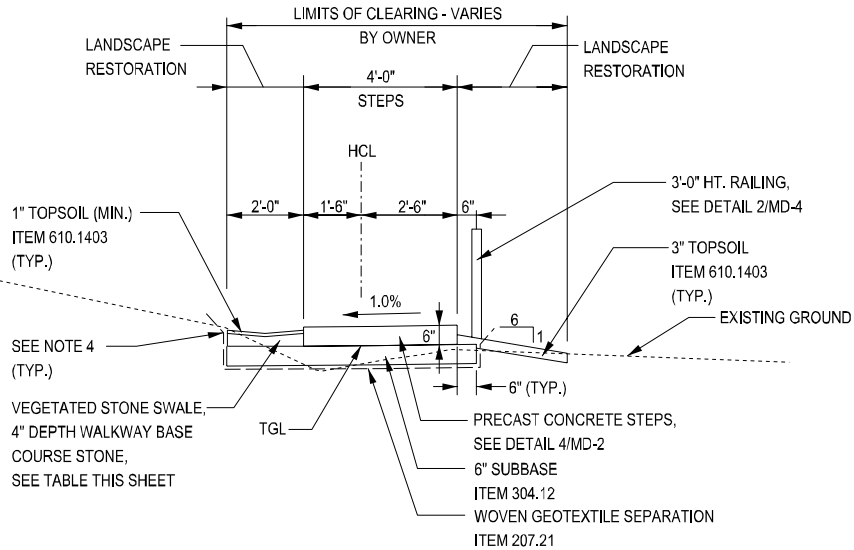

TYPICAL SECTION NO. 3  
NOT TO SCALE  
LOCATIONS:  
STA. 11+54.50 TO STA. 11+96.50

| BASE COURSE STONE GRADATION |                         |
|-----------------------------|-------------------------|
| NYSDOT STONE                | COMPOSITION (BY WEIGHT) |
| ITEM 304.12                 | 60%                     |
| #4A STONE                   | 40%                     |

WALKWAY BASE COURSE NOTES:

- ALL NYSDOT STANDARD SPECIFICATIONS OF ITEM 304.12 SHALL APPLY TO THE WALKWAY BASE COURSE EXCEPT THE GRADATION SHALL BE AS SPECIFIED IN THE TABLE ABOVE AND ITEM 304.12 SHALL BE A PRODUCT OF CRUSHED LIMESTONE ONLY.
- NYSDOT #4A STONE SHALL BE 100% FRACTURED STONE.
- CONTRACTOR SHALL MIX A 3 CY SAMPLE OF WALKWAY BASE COURSE STONE FOR TOWN'S REPRESENTATIVE TO VISUALLY INSPECT AT QUARRY. COST INCLUDED IN WALKWAY BID ITEM.

NOTES:

- TRAIL ALIGNMENT, PROFILE, AND CROSS SLOPE MAY BE ADJUSTED BASED ON FIELD CONDITIONS WITH CONCURRENCE OF TOWN'S REPRESENTATIVE. ADJUSTMENTS SHALL BE DESIGNED TO ENSURE POSITIVE DRAINAGE OFF THE WALKWAY. 1.5% CROSS SLOPE IS MAXIMUM.
- FIBER ROLLS SHALL BE INSTALLED ALONG THE DOWN GRADIENT LIMIT OF CONSTRUCTION AREAS.
- THE FINISHED PROFILE OF THE WALKWAY SHALL BE CONSTRUCTED SO AS TO MINIMIZE BUMPS, DIPS, OR OTHER OBJECTIONABLE IRREGULARITIES, AS DETERMINED BY THE TOWN'S REPRESENTATIVE.
- WHEN PLACING ITEM 207.21 GEOTEXTILE SEPARATION, BE SURE TO ACCOUNT FOR "DRAG" WHEN PLACING WALKWAY BASE COURSE STONE. TRIM EXCESS FABRIC TO GRADE AFTER BASE COURSE STONE PLACEMENT.
- KEY IN BASE COURSE STONE AT TOE OF SLOPE TIE-IN FOR THE PURPOSE OF ANCHORING STONE.
- TRANSITIONS IN WALKWAY CROSS SLOPE SHALL BE PROVIDED AT A RATE OF 5 LF PER 1.0% CHANGE IN CROSS SLOPE. TRANSITION LIMITS ARE AS FOLLOWS:  
STA. 10+40.00 TO STA. 10+55.00; STA. 11+87.50 TO STA. 12+00.00; STA. 13+35.00 TO STA. 13+50.00

PREPARED BY: BARTON & LOGUIDICE, D.P.C.  
ON : APRIL 2021



PREPARED BY: BARTON & LOGUIDICE, D.P.C.  
ON : APRIL 2021



NOTES:

1. TRAIL ALIGNMENT, PROFILE, AND CROSS SLOPE MAY BE ADJUSTED BASED ON FIELD CONDITIONS WITH CONCURRENCE OF TOWN'S REPRESENTATIVE. ADJUSTMENTS SHALL BE DESIGNED TO ENSURE POSITIVE DRAINAGE OFF THE WALKWAY. 1.5% CROSS SLOPE IS MAXIMUM.
2. FIBER ROLLS SHALL BE INSTALLED ALONG THE DOWN GRADIENT LIMIT OF CONSTRUCTION AREAS.
3. THE FINISHED PROFILE OF THE WALKWAY SHALL BE CONSTRUCTED SO AS TO MINIMIZE BUMPS, DIPS, OR OTHER OBJECTIONABLE IRREGULARITITES, AS DETERMINED BY THE TOWN'S REPRESENTATIVE.
4. WHEN PLACING ITEM 207.21 GEOTEXTILE SEPARATION, BE SURE TO ACCOUNT FOR "DRAG" WHEN PLACING WALKWAY BASE COURSE STONE. TRIM EXCESS FABRIC TO GRADE AFTER BASE COURSE STONE PLACEMENT.
5. KEY IN BASE COURSE STONE AT TOE OF SLOPE TIE-IN FOR THE PURPOSE OF ANCHORING STONE.
6. TRANSITIONS IN WALKWAY CROSS SLOPE SHALL BE PROVIDED AT A RATE OF 5 LF PER 1.0% CHANGE IN CROSS SLOPE. TRANSITION LIMITS ARE AS FOLLOWS:  
  
STA. 10+40.00 TO STA. 10+55.00; STA. 11+87.50 TO STA. 12+00.00; STA. 13+35.00 TO STA. 13+50.00

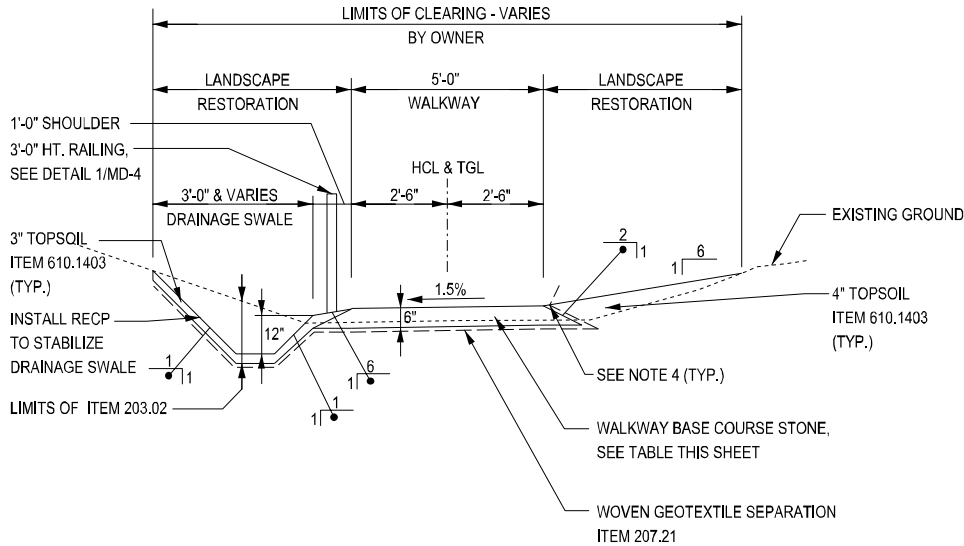

TYPICAL SECTION NO. 6  
NOT TO SCALE  
LOCATIONS:  
STA. 15+07.00 TO STA. 15+56.40

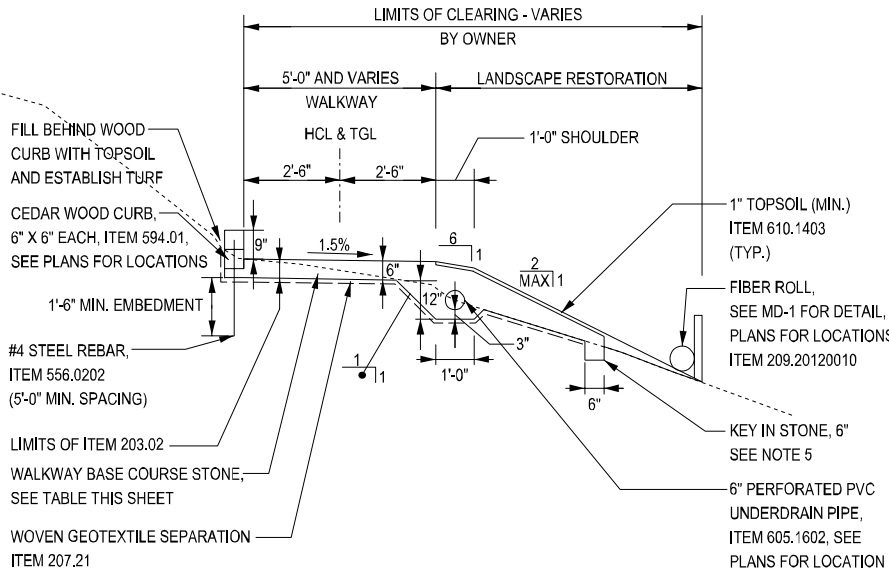

TYPICAL SECTION NO. 4  
NOT TO SCALE  
LOCATIONS:  
STA. 11+96.50 TO STA. 13+50.00

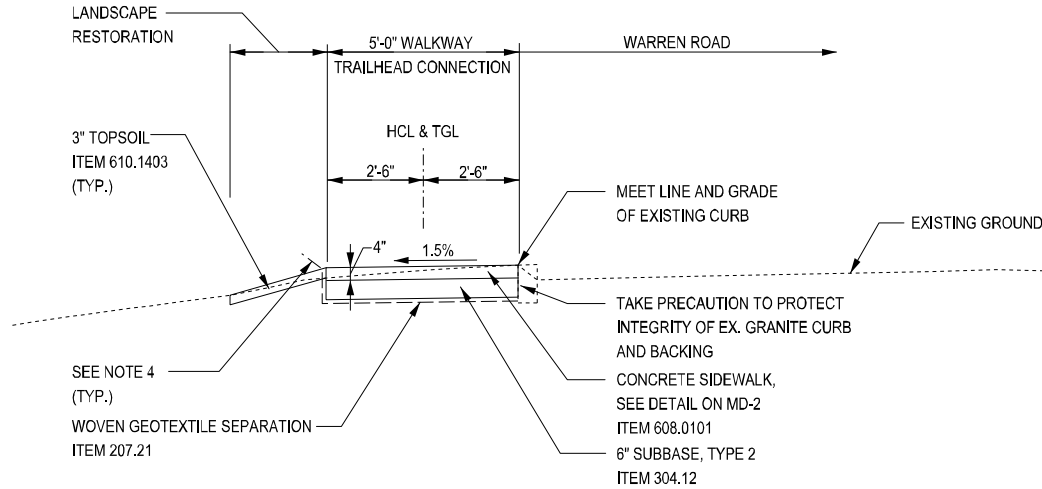

TYPICAL SECTION NO. 7  
NOT TO SCALE  
LOCATIONS:  
WALKWAY TRAILHEAD/CONNECTION (PL-3)

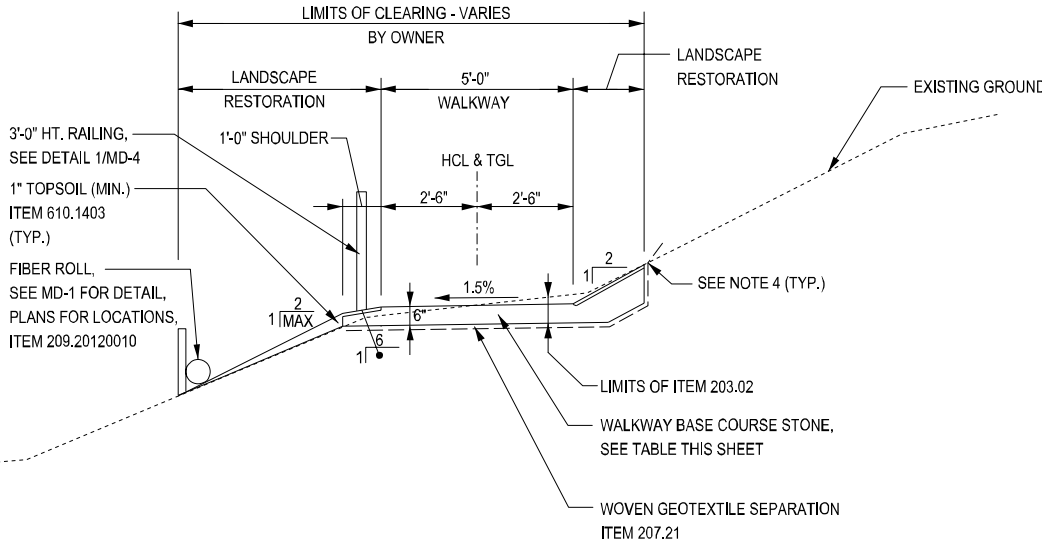

TYPICAL SECTION NO. 5  
NOT TO SCALE  
LOCATIONS:  
STA. 13+50.00 TO STA. 15+07.00

| BASE COURSE STONE GRADATION |                         |
|-----------------------------|-------------------------|
| NYSDOT STONE                | COMPOSITION (BY WEIGHT) |
| ITEM 304.12                 | 60%                     |
| #4A STONE                   | 40%                     |

WALKWAY BASE COURSE NOTES:

1. ALL NYSDOT STANDARD SPECIFICATIONS OF ITEM 304.12 SHALL APPLY TO THE WALKWAY BASE COURSE EXCEPT THE GRADATION SHALL BE AS SPECIFIED IN THE TABLE ABOVE AND ITEM 304.12 SHALL BE A PRODUCT OF CRUSHED LIMESTONE ONLY.
2. NYSDOT #4A STONE SHALL BE 100% FRACTURED STONE.
3. CONTRACTOR SHALL MIX A 3 CY SAMPLE OF WALKWAY BASE COURSE STONE FOR TOWN'S REPRESENTATIVE TO VISUALLY INSPECT AT QUARRY. COST INCLUDED IN WALKWAY BID ITEM.

FOREST HOME WALKWAY IMPROVEMENTS  
FINAL DESIGN

TOWN OF ITHACA

TOMPKINS COUNTY

**Barton & Loguidice**

UNAUTHORIZED ALTERATION OR ADDITION TO THIS  
DRAWING IS A VIOLATION OF THE NEW YORK STATE  
EDUCATION LAW ARTICLE 145 SECTION 7209



NO. DATE BY REVISION

4  
1.3

TYPICAL  
SECTIONS - 2

SCALE: AS SHOWN  
DATE ISSUED: 04/2021  
DRAWING  
TS-2



PREPARED BY: BARTON & LOGUIDICE, D.P.C.  
ON: APRIL 2021



NOTES:

1. SURVEY PERFORMED BY T.G. MILLER P.C. ENGINEERS AND SURVEYORS, COMPLETED IN MAY 2019.
2. HORIZONTAL DATUM IS REFERENCED TO THE NEW YORK STATE PLANE COORDINATE SYSTEM, CENTRAL ZONE, NAD83 THROUGH GPS REAL TIME OBSERVATIONS USING NYSNET CONTINUOUS OPERATING REFERENCE STATIONS.
3. VERTICAL DATUM IS NAVD88 PER THE NYSNET CONTINUOUS OPERATING REFERENCE STATIONS.
4. UNDERGROUND UTILITIES HAVE BEEN LOCATED FROM AVAILABLE RECORDS, FIELD LOCATIONS OF ABOVE GROUND STRUCTURES AND ANY MARKINGS PROVIDED BY THE UTILITY AUTHORITY. THEREFORE, THESE LOCATIONS MUST BE CONSIDERED APPROXIMATE. THERE MAY BE OTHER UNDERGROUND UTILITIES AND/OR STRUCTURES, THE LOCATION AND EXISTENCE OF WHICH IS NOT PRESENTLY KNOWN. LOCATIONS, SIZES AND MATERIALS OF UNDERGROUND UTILITIES ARE BASED ON BEST AVAILABLE EVIDENCE AS NOTED ABOVE. VERIFY ALL UTILITIES PRIOR TO DESIGN OR CONSTRUCTION.
5. IN THE EVENT THAT THERE IS A DISCREPANCY BETWEEN THE CONTENTS OF THE SIGNED AND SEALED HARD COPY DRAWING AND THE CORRESPONDING DIGITAL DRAWING FILE, THE HARD COPY WITH AN ORIGINAL STAMP AND SIGNATURE SHALL BE THE CONTROLLING DOCUMENT.
6. OUTLINE OF BUILDINGS SHOWN HEREON ARE THE AT GRADE FOOTPRINT. ARCHITECT TO VERIFY BUILDING DIMENSIONS PRIOR TO DESIGN OR CONSTRUCTION.
7. THIS SURVEY MAP PREPARED WITHOUT BENEFIT OF AN ABSTRACT OF TITLE PROVIDED, SUBJECT TO ANY STATE OF FACT THAT AN UPDATED ABSTRACT OF TITLE MAY SHOW.

ROAD NAME

(3 ROD RIGHT OF WAY=49.5')  
PRESENT CENTERLINE  
R/W  
FACE OF CURB  
CURB CUT  
STREET LINE  
CONCRETE WALK

LEGEND

- △ -COMPUTED POINT
- -PIN SET WITH CAP
- + -IRON PIN FOUND
- ⊕ -IRON PIPE FOUND
- ⊙ -UTILITY POLE
- -TELEPHONE PEDESTAL
- FENCE & HEDGE
- \* -PROPOSED NEW DIVISION LINE
- GRANITE HIGHWAY MONUMENT FOUND
- ▲ -CONCRETE HIGHWAY MONUMENT FOUND

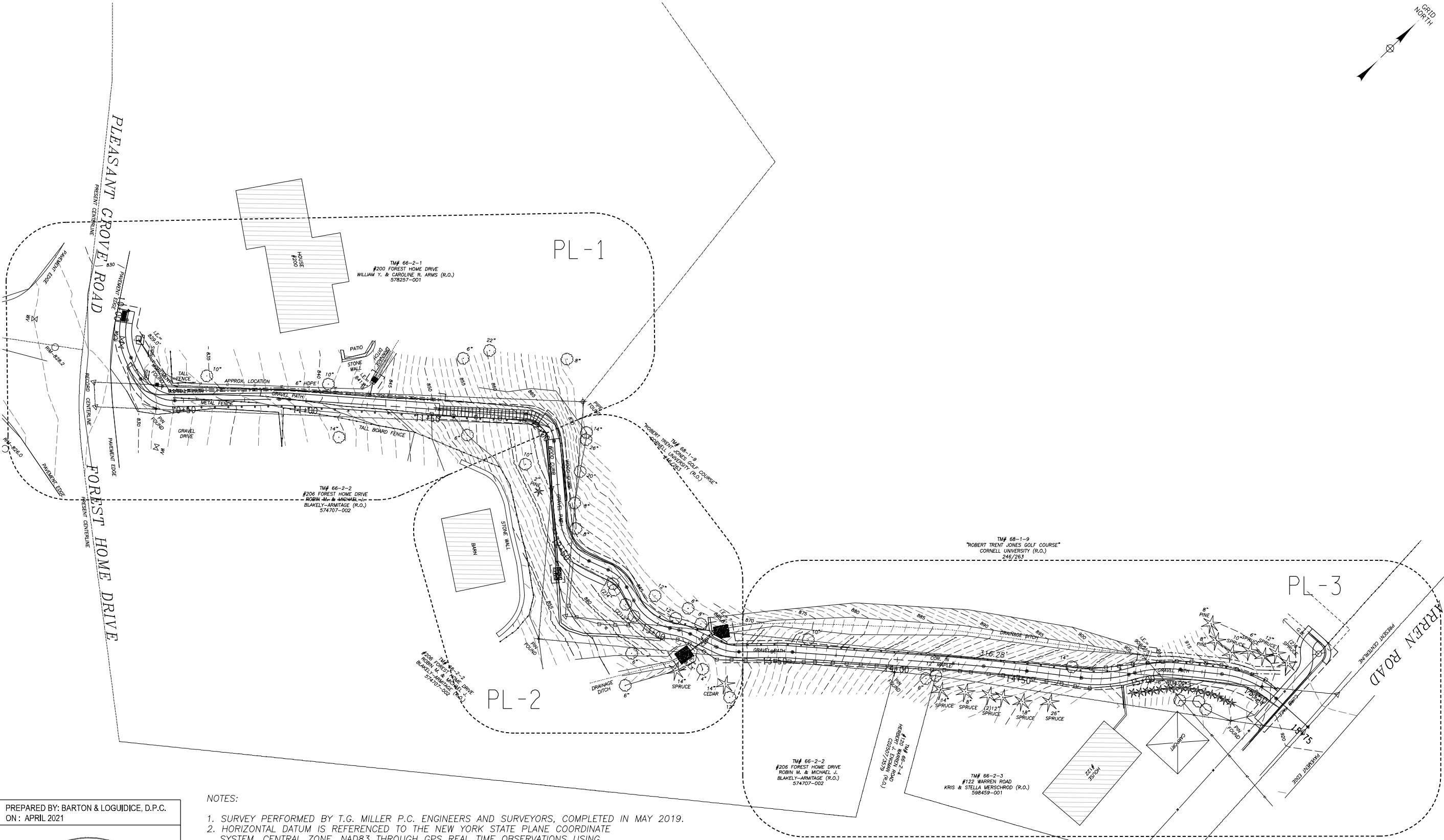
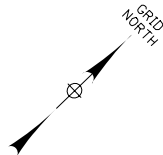
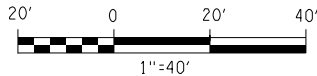

|   |  |      |    |          |
|---|--|------|----|----------|
| NO.   |  | DATE | BY | REVISION |
| 5   |  |      |    |          |
| 13  |  |      |    |          |
|   |  |      |    |          |
| <b>Barton &amp; Loguidice</b>   |  |      |    |          |
| UNAUTHORIZED ALTERATION OR ADDITION TO THIS DRAWING IS A VIOLATION OF THE NEW YORK STATE EDUCATION LAW ARTICLE 145 SECTION 7209 |  |      |    |          |
| FOREST HOME WALKWAY IMPROVEMENTS<br>FINAL DESIGN  |  |      |    |          |
| TOWN OF ITHACA  |  |      |    |          |
| TOMPKINS COUNTY   |  |      |    |          |
| SITE LAYOUT PLAN -<br>KEY PLAN  |  |      |    |          |
| SCALE: AS SHOWN   |  |      |    |          |
| DATE ISSUED: 04/2021  |  |      |    |          |
| DRAWING<br>KM-1   |  |      |    |          |

\\microstation\Bentley\_V8\Workspace\Plot\Site\_NY5001\_Size\_B\_XEROX.tbl  
\\microstation\Bentley\_V8\Workspace\Plot\mysdot.xrn c60-fierypit

FILE NAME = I:\Shared\2000\2071002\2071003\_p101.dgn  
DATE = 3/29/2021  
TIME = 3:06:58 PM

IN CHARGE OF CAW DESIGN BY AAM CHECKED BY KFE ESTIMATED BY KFE CHECKED BY RSB DRAFTED BY AAM/RSB CHECKED BY KFE

PREPARED BY: BARTON & LOGUIDICE, D.P.C.  
ON : APRIL 2021



LEGEND:

- INLET/OUTLET PROTECTION
- FIBER ROLL
- RAILING
- NEW STORM PIPE
- LIMITS OF DISTURBANCE
- FILL LINE
- CUT LINE
- X MD-X  
X = DETAIL NO.  
MD-X = DRAWING NO.

NOTES:

- ROOT PRUNING: PRIOR TO EXCAVATING, A COMPRESSED AIR EXCAVATION DEVICE SHALL BE USED ALONG THE CUT LINE OF THE PROPOSED EXCAVATION TO DETERMINE THE LOCATION OF THE TREE ROOTS. ROOTS SHALL BE CUT CLEANLY WITH A HAND SAW OR LOPPERS.

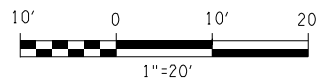
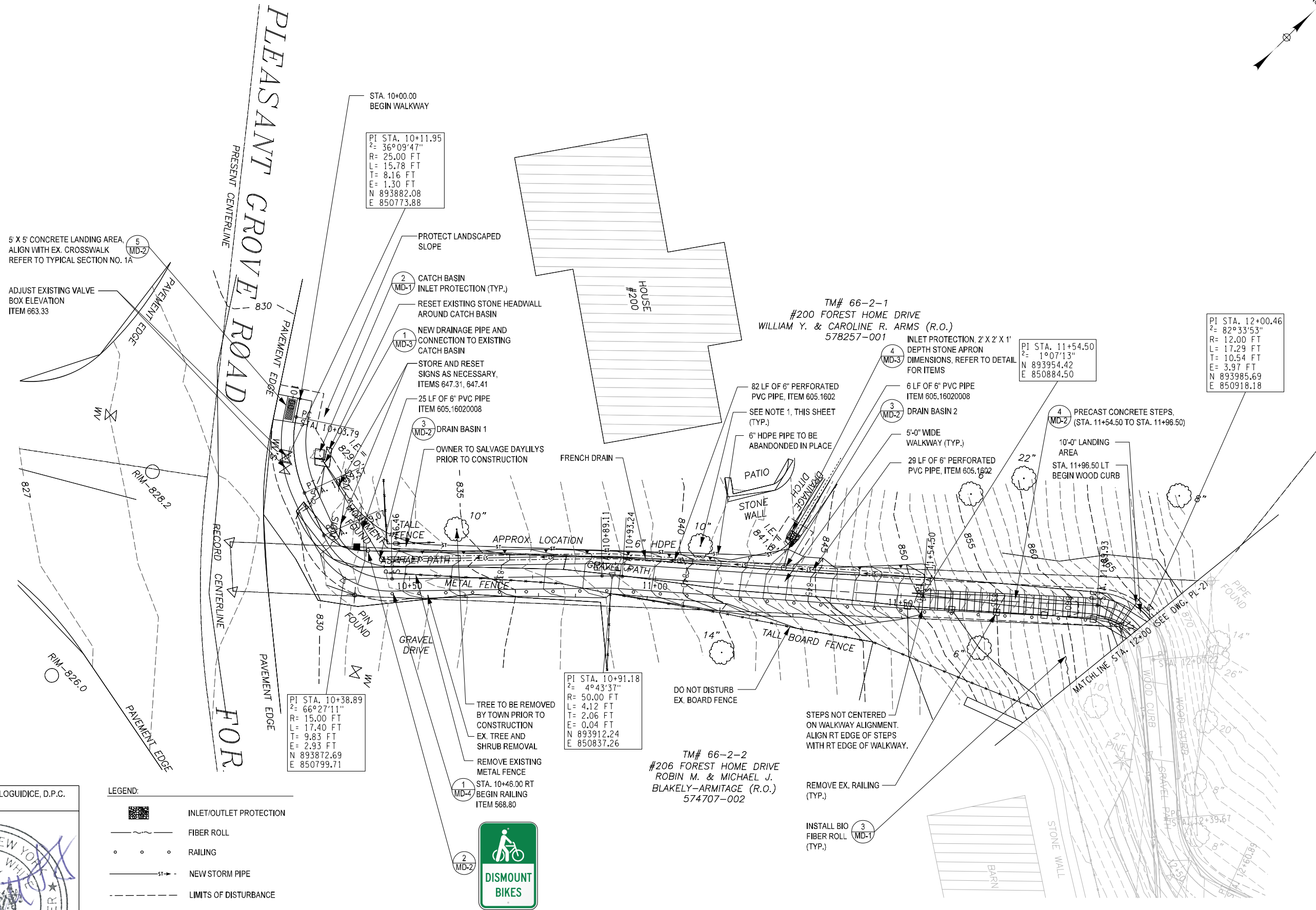

|  |  |   |  |
|--|--|---|--|
| NO. DATE BY REVISION                             |  | 6<br>13   |  |
|  |  | UNAUTHORIZED ALTERATION OR ADDITION TO THIS DRAWING IS A VIOLATION OF THE NEW YORK STATE EDUCATION LAW ARTICLE 145 SECTION 7209 |  |
| FOREST HOME WALKWAY IMPROVEMENTS<br>FINAL DESIGN |  | TOWN OF ITHACA<br>TOMPKINS COUNTY   |  |
| SITE LAYOUT<br>PLAN - 1                          |  | SCALE: AS SHOWN<br>DATE ISSUED: 04/2021<br>DRAWING<br>PL-1  |  |



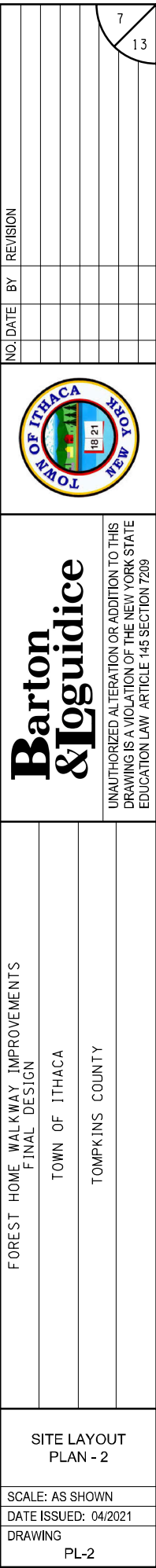

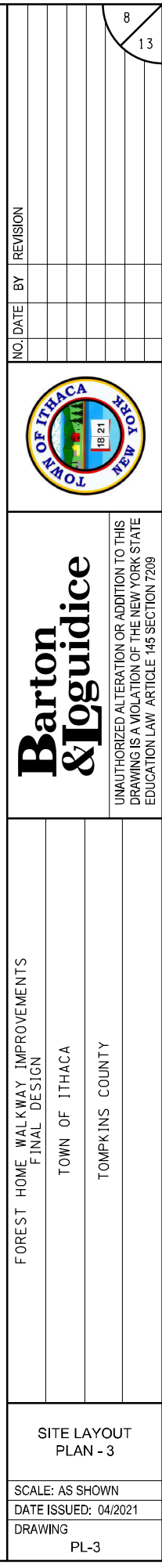





eam  
I:\MicroStation\Bentley V8\Workspace\Plot\SITE\_NYSDOT\_SIZE\_B\_XEROX.tbl  
it:\microstation\Bentley V8\workspace\plot\mysdot.xrn c60-fierfypit

FILE NAME = I:\Shared\2000\2071002\2071003.profiledgn  
DATE = 3/29/2021  
TIME = 3:01:10 PM

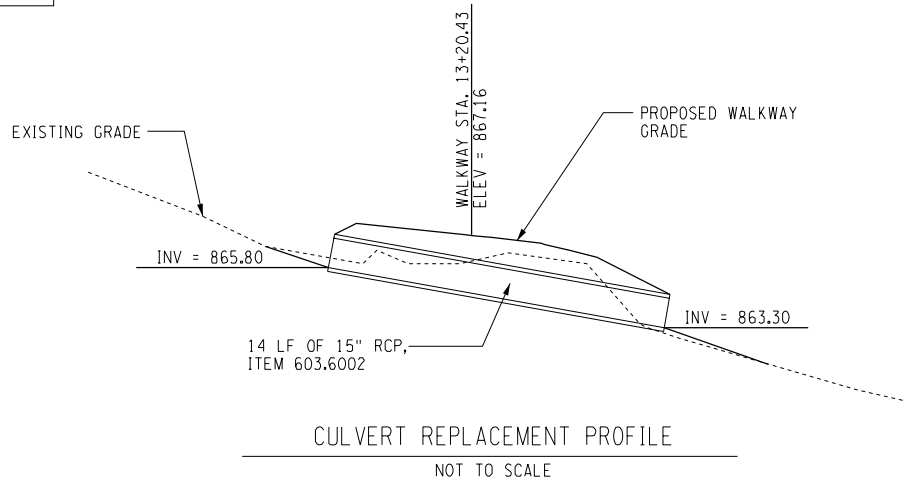
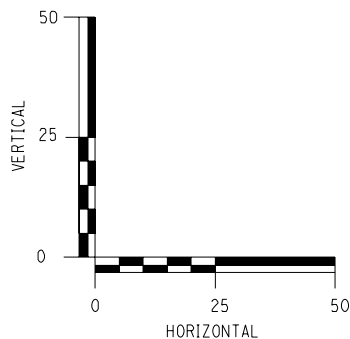
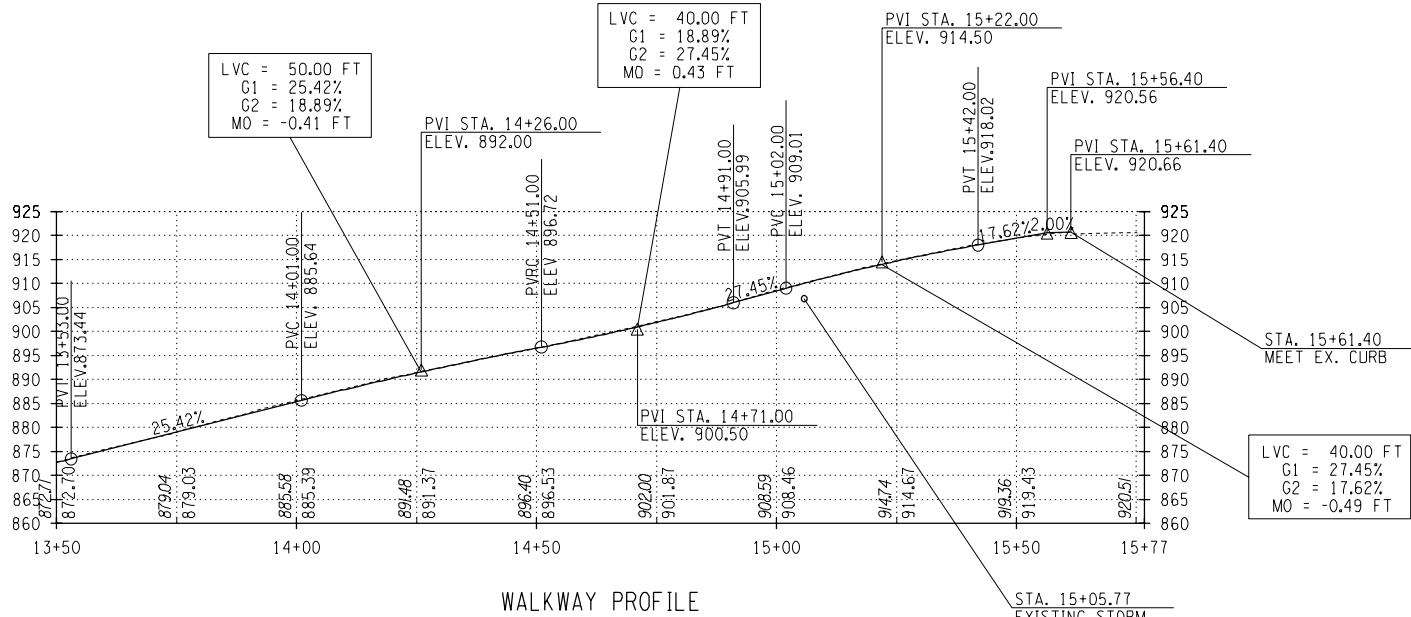
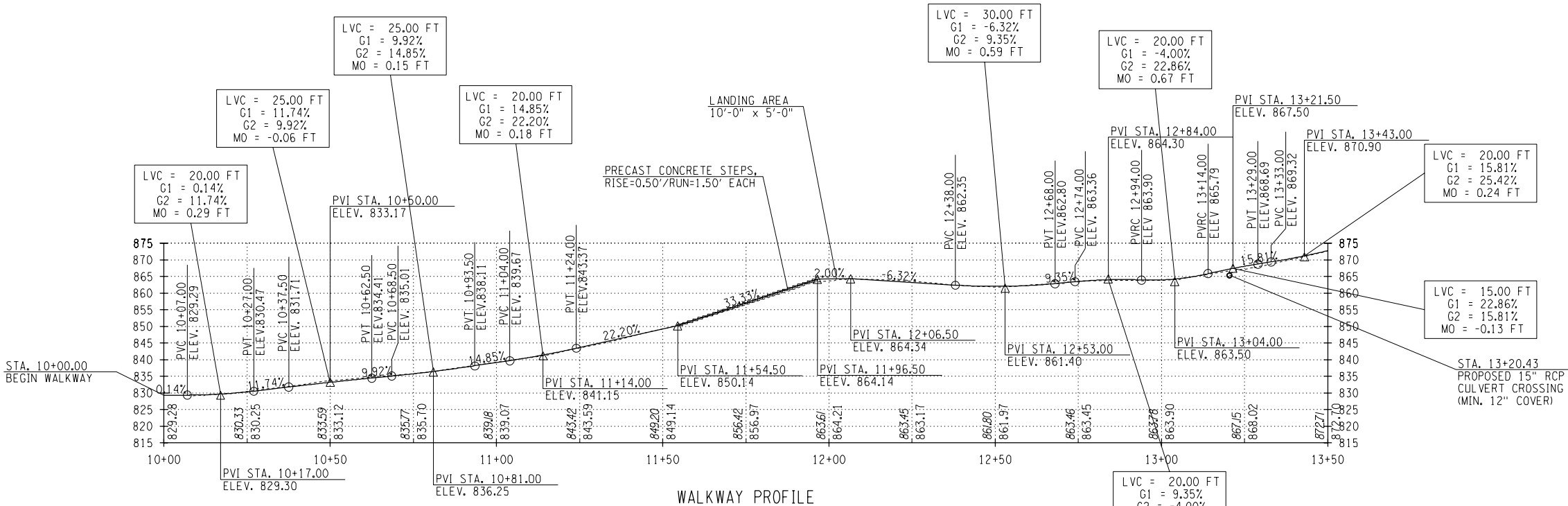
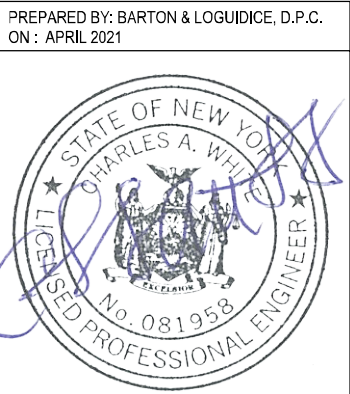
IN CHARGE OF CAW DESIGN BY AAM CHECKED BY KFE ESTIMATED BY RSB CHECKED BY AAM DRAFTED BY AAM/RSB CHECKED BY KFE



|   |  |                      |  |
|---|--|----------------------|--|
| <div>9</div> <div>13</div>  |  |                      |  |
|   |  |                      |  |
|   |  |                      |  |
|   |  |                      |  |
|   |  |                      |  |
|   |  |                      |  |
|   |  |                      |  |
|   |  |                      |  |
|   |  |                      |  |
|   |  |                      |  |
|   |  | NO. DATE BY REVISION |  |
|    |  |                      |  |
| <div><div><div>Barton &amp; Loguidice</div></div><div>UNAUTHORIZED ALTERATION OR ADDITION TO THIS<br/>DRAWING IS A VIOLATION OF THE NEW YORK STATE<br/>EDUCATION LAW ARTICLE 145 SECTION 7209</div></div> |  |                      |  |
|   |  |                      |  |
| FOREST HOME WALKWAY IMPROVEMENTS<br>FINAL DESIGN  |  |                      |  |
| TOWN OF ITHACA  |  |                      |  |
| TOMPKINS COUNTY   |  |                      |  |
| WALKWAY<br>PROFILE  |  |                      |  |
| SCALE: AS SHOWN   |  |                      |  |
| DATE ISSUED: 04/2021  |  |                      |  |
| DRAWING   |  |                      |  |
| PRO-1   |  |                      |  |



- PRIOR TO AND DURING CONSTRUCTION:**

- 1  
MD-1
- TEMPORARY TREE PROTECTION FENCE - 611.21050009
- NOT TO SCALE



- 2  
MD-1
- CATCH BASIN INLET PROTECTION - ITEM 209.2301  
NOT TO SCALE



- 3  
MD-1
- BIO-FIBER ROLL - ITEM 209.20120010
- NOT TO SCALE

- FIBER ROLL GENERAL NOTES:

- | SLOPES | S    |
|--------|------|
| 1:2    | 25'  |
| 1:3    | 80'  |
| 1:4    | 130' |
| 1:5    | 200' |

- RECP NOTES:

- 4 ROLLED EROSION CONTROL PRODUCT FOR GREATER THAN 3:1 SLOPE  
MD-1 NOT TO SCALE

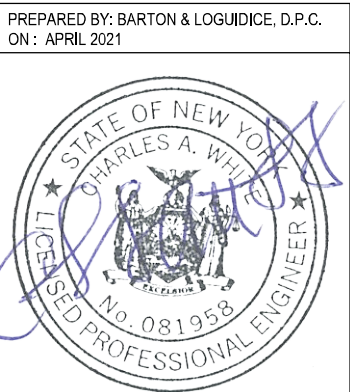



FILE NAME = I:\Shared\2000\2071002\2071003\_md02.dgn  
DATE = 3/29/2021  
TIME = 3:07:14 PM

eam  
I:\MicroStation\Bentley v8i\Workspace\Plot\SITE\_NYSDOT\_SIZE\_B\_XEROX.tbl  
it:\microstation\Bentley v8i\workspace\plot\mysdot.xrn c60-fierypit

IN CHARGE OF CAW DESIGN BY AAM CHECKED BY RSB ESTIMATED BY KFE DRAFTED BY AAM CHECKED BY AAM/RSB CHECKED BY KFE

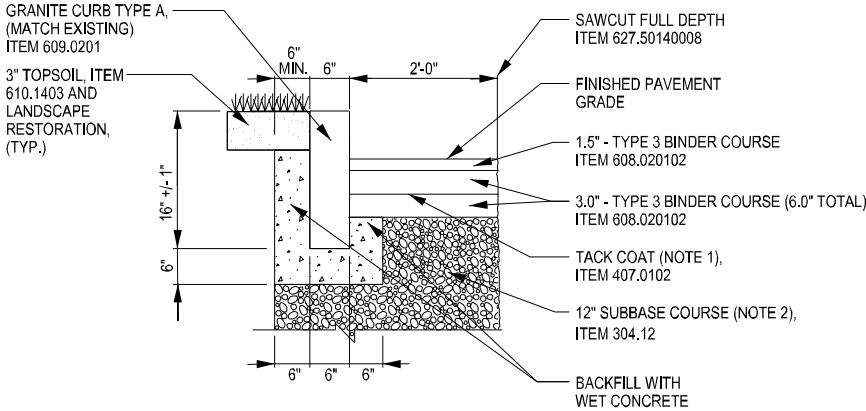

1  
MD-2

**GRANITE CURB DETAIL**  
NOT TO SCALE

**GRANITE CURB NOTES:**

- TACK COAT SHALL BE PLACED BETWEEN ALL LIFTS OF ASPHALT.
- ITEM 304.12 SHALL BE INSTALLED TO A DEPTH OF 12" OR 2" BELOW EXISTING SUBBASE, WHICHEVER IS GREATER.

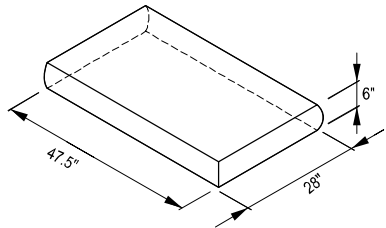

**STEP SECTION**  
A-3SC THREE-SIDED

BLOCK WEIGHT: 660 LB (300 KG)  
BLOCK VOLUME: 4.59 CF (0.130 CM)

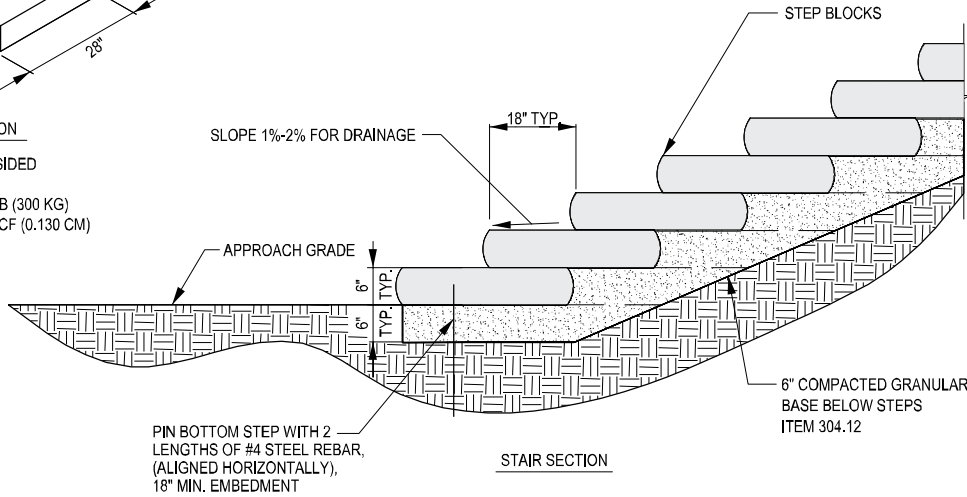

**STAIR SECTION**

4  
MD-2

**PRECAST CONCRETE STEPS DETAIL**  
NOT TO SCALE

**PRECAST CONCRETE STEP NOTES**

- UNITS FOR DIMENSIONS ARE IN INCHES, TYPICAL UNLESS NOTED OTHERWISE.
- ACTUAL BLOCK VOLUMES AND WEIGHTS MAY VARY.
- WEIGHTS ARE BASED UPON A CONCRETE DENSITY OF 143 LB/CF (2291 KG/CM).
- PRECAST CONCRETE STEP SHALL BE MANUFACTURED BY REDI-ROCK OR APPROVED EQUAL.

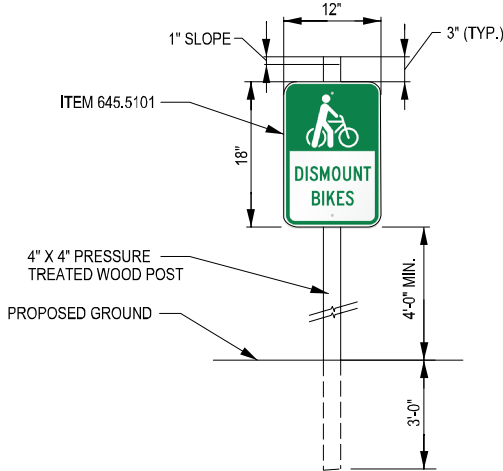

2  
MD-2

**WOODEN SIGN POST DETAIL - ITEM 645.82**  
NOT TO SCALE

**SIGN POST NOTES:**

- BACKFILL WITH SELECT STRUCTURAL FILL, ITEM 203.21, OR SUITABLE MATERIAL.

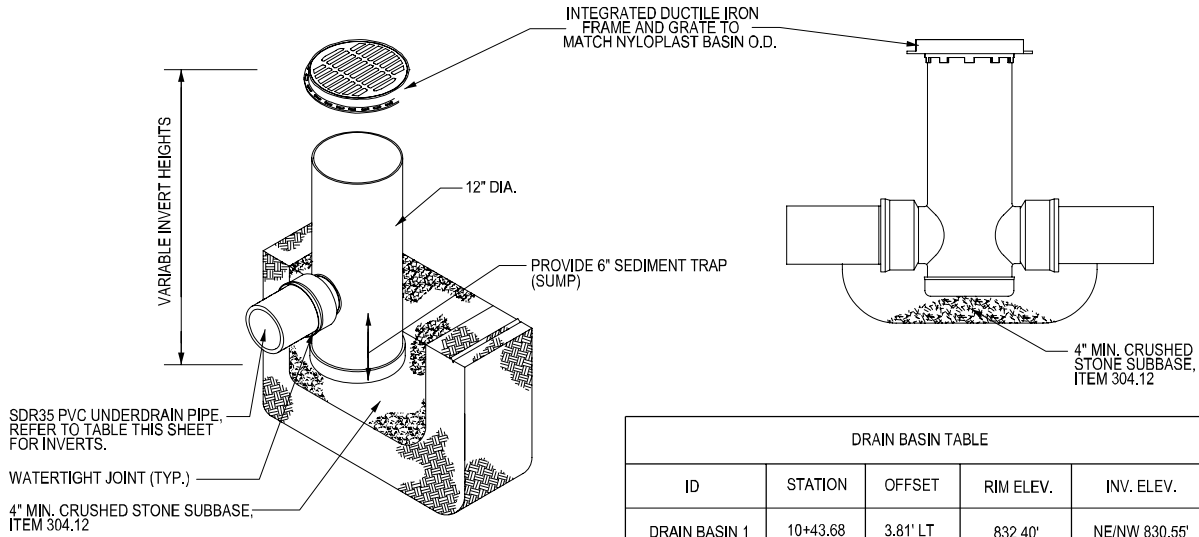

| DRAIN BASIN TABLE |          |          |           |                  |
|-------------------|----------|----------|-----------|------------------|
| ID                | STATION  | OFFSET   | RIM ELEV. | INV. ELEV.       |
| DRAIN BASIN 1     | 10+43.68 | 3.81' LT | 832.40'   | NE/NW 830.55'    |
| DRAIN BASIN 2     | 11+25.86 | 4.00' LT | 843.60'   | NW/NE/SW 841.75' |

3  
MD-2

**DRAIN BASIN WITH STANDARD GRATE**  
NOT TO SCALE

**DRAIN BASIN NOTES:**

- DIMENSIONS ARE FOR REFERENCE ONLY. ACTUAL DIMENSIONS MAY VARY.
- 12" FRAME AND GRATE SHALL BE DUCTILE IRON PER ASTM A536 GRADE 70-50-05. GRATE SHALL MEET H-20 LOAD RATING. GRATE SHALL BE LOCKABLE. CASTING TO BE FURNISHED WITH A BLACK PAINT.
- DRAIN BASIN TO BE CUSTOM MANUFACTURED ACCORDING TO PLAN DETAILS.
- DRAINAGE CONNECTION STUB JOINT TIGHTNESS SHALL CONFORM TO ASTM D3212 FOR CORRUGATED HDPE (ADS N-12/HANCOR DUAL WALL), N-12 HP & PVC SEWER (4"-24").
- ADAPTERS CAN BE MOUNTED ON ANY ANGLE 0 TO 360 DEGREES. REFER TO TABLE THIS SHEET FOR PIPE INVERTS AND PLANS FOR ENTRY ANGLES.
- MANUFACTURER OF DRAIN BASIN AND GRATE SHALL BE NYLOPLAST OR APPROVED EQUAL.

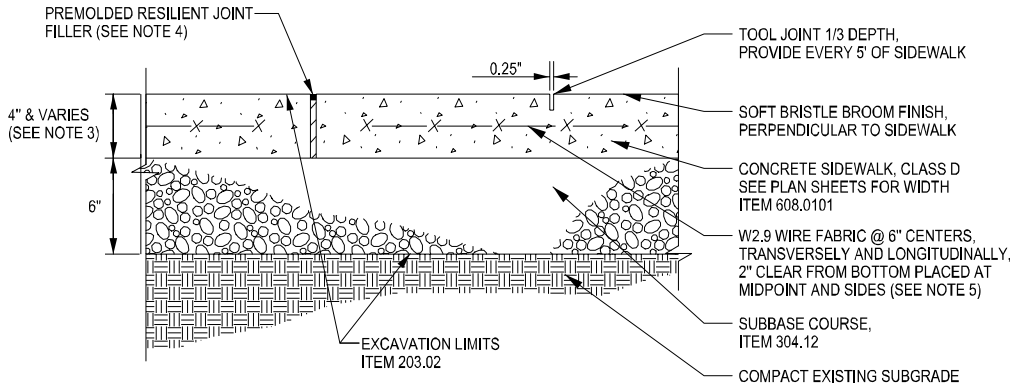

5  
MD-2

**CONCRETE SIDEWALK DETAIL**  
NOT TO SCALE

**SIDEWALK NOTES**

- CONTRACTOR SHALL LAYOUT ALL SIDEWALK, CURB, AND LIMITS OF WORK NECESSARY TO MEET EXISTING GRADE FOR APPROVAL BY THE TOWN'S REPRESENTATIVE PRIOR TO PROGRESSING ANY EXCAVATION.
- ADJUSTMENTS CAN BE MADE TO THE DIRECTION OF CROSS SLOPES, BUT THE CROSS SLOPE CANNOT EXCEED 1.5%. PROVIDE A MINIMUM SLOPE OF 0.5% FOR DRAINAGE. ALL CROSS SLOPE ADJUSTMENTS SHALL BE APPROVED BY THE TOWN'S REPRESENTATIVE.
- SIDEWALK LANDING THICKNESS SHALL BE 6" AT FOREST HOME DRIVE.
- TRANSVERSE CONSTRUCTION JOINTS SHALL EXTEND TO THE FULL DEPTH OF CONCRETE. PREMOLDED RESILIENT JOINT FILLER SHALL BE INSTALLED AT ALL JOINTS BETWEEN SIDEWALK AND CURB, PAVEMENT AND MISCELLANEOUS HARD OBJECTS.
- WIRE FABRIC SHALL BE USED ONLY AT SIDEWALK LANDING AT FOREST HOME DRIVE.

PREPARED BY: BARTON & LOGUIDICE, D.P.C.  
ON : APRIL 2021



|  |  |   |  |
|--|--|---|--|
| NO. DATE BY REVISION                             |  | 11<br>13  |  |
| TOWN OF ITHACA                                   |  | TOWN OF ITHACA  |  |
| Barton & Loguidice                               |  | UNAUTHORIZED ALTERATION OR ADDITION TO THIS DRAWING IS A VIOLATION OF THE NEW YORK STATE EDUCATION LAW ARTICLE 145 SECTION 7209 |  |
| FOREST HOME WALKWAY IMPROVEMENTS<br>FINAL DESIGN |  | TOWN OF ITHACA<br>TOMPKINS COUNTY   |  |
| MISCELLANEOUS<br>DETAILS                         |  | SCALE: AS SHOWN<br>DATE ISSUED: 04/2021<br>DRAWING<br>MD-2  |  |



1. CORE NEW OPENING IN STRUCTURE WALL LARGE ENOUGH TO ACCOMMODATE NEW LATERAL CONNECTION.
2. CLEAN OPENING ALL AROUND, REMOVING ALL LOOSE MATERIALS. REPAIR ANY DAMAGE TO THE DRAINAGE STRUCTURE THAT IS A RESULT OF THE CORING.
3. INSERT NEW LATERAL THRU MANHOLE OPENING AND MAKE CONNECTION WATERTIGHT. SEAL ANY VOID BETWEEN OPENING AND LATERAL CONNECTION WITH EPOXY MORTAR.

MD



2  
MD



PLAN

ELEVATION

4  
MD

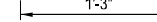

FRONT VIEW

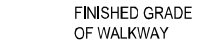

1. STONE HEADWALL TO BE INSTALLED AT PROPOSED INLET AND OUTLET OF CULVERT CROSSING AT STA. 13+20.43.
2. SALVAGE AND RESET STONE FROM EXISTING HEADWALL. PROVIDE ADDITIONAL NATURAL QUARRY STONE OF SIMILAR SIZE AS NEEDED.



SLOTTED HEADWALL DETAIL  
TOP VIEW

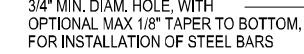

SIDE VIEW



PREPARED BY: BARTON & LOGUIDICE, D.P.C.  
ON : APRIL 2021

STONE APRON NOTES:

1. TEMPORARY WATER DIVERSION STRUCTURES SHALL BE USED AT LOCATIONS, AS DIRECTED BY THE ENGINEER, WHERE A CONTINUOUS WATER FLOW IS PRESENT.

# FOREST HUME WALKWAY IMPROVEMENTS FINAL DESIGN

TOWN OF ITHACA

TOMPKINS COUNTY

## MISCELLANEOUS DETAILS

SCALE: AS SHOWN

DATE ISSUED: 04/2021

DRAWING  
MD-3



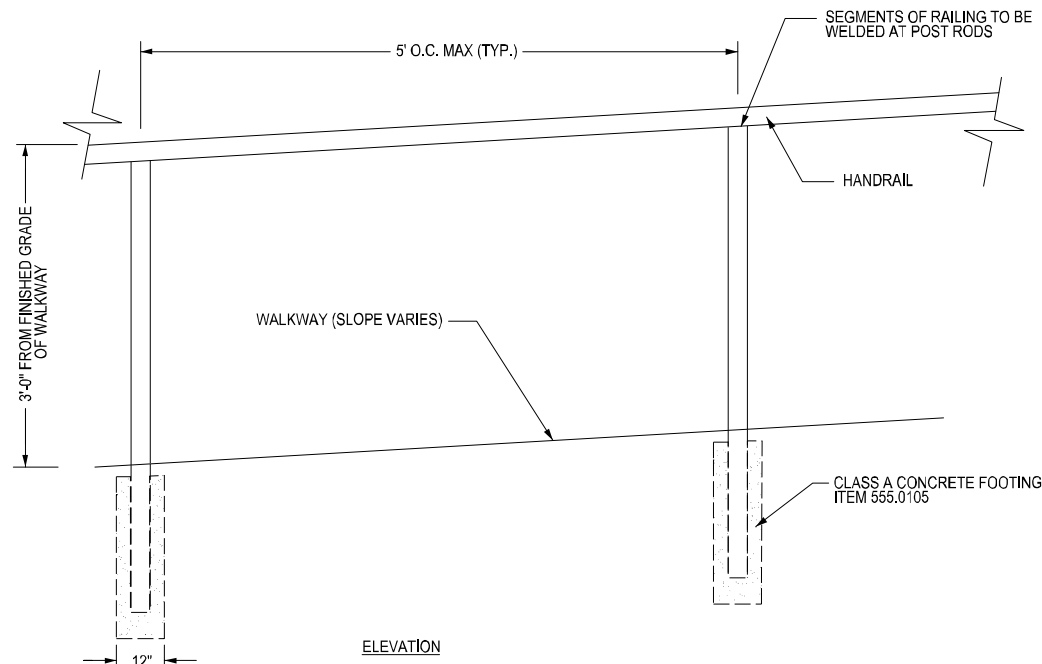

NOTES:

1. 1/8 INCH WEEP HOLES ARE REQUIRED AT BOTTOM AND LOW POINTS OF RAILS AND POSTS.
2. PIPE RAIL SHALL BE HOT DIP GALVANIZED AND POWDER COATED BLACK.
3. HANDRAIL SHALL BE CONTINUOUS. ALL ENDS TO BE CAPPED.
4. ALL SHARP EDGES TO BE GROUND SMOOTH. ALL FIELD WELDING SHALL BE GROUND SMOOTH AND PAINT TOUCHED UP IN THE FIELD.
5. CONTRACTOR SHALL SUBMIT SHOP DRAWINGS FOR APPROVAL.

| RAILING TABLE |              |             |      |             |
|---------------|--------------|-------------|------|-------------|
| START STATION | STOP STATION | OFFSET (FT) | SIDE | LENGTH (FT) |
| 10+46.00      | 12+06.00     | 3.00        | RT   | 160.0       |
| 13+00.00      | 15+56.00     | 3.00        | LT   | 256.0       |

PREPARED BY: BARTON & LOGUIDICE, D.P.C.  
ON : APRIL 2021

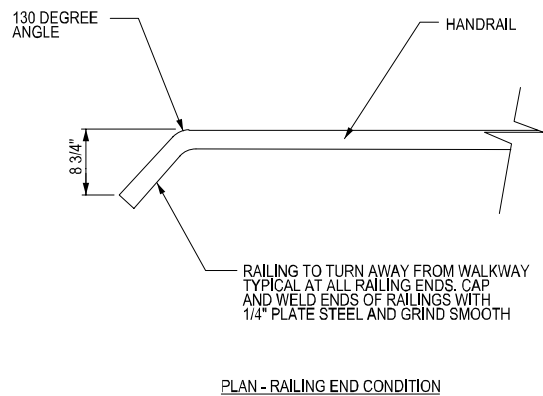
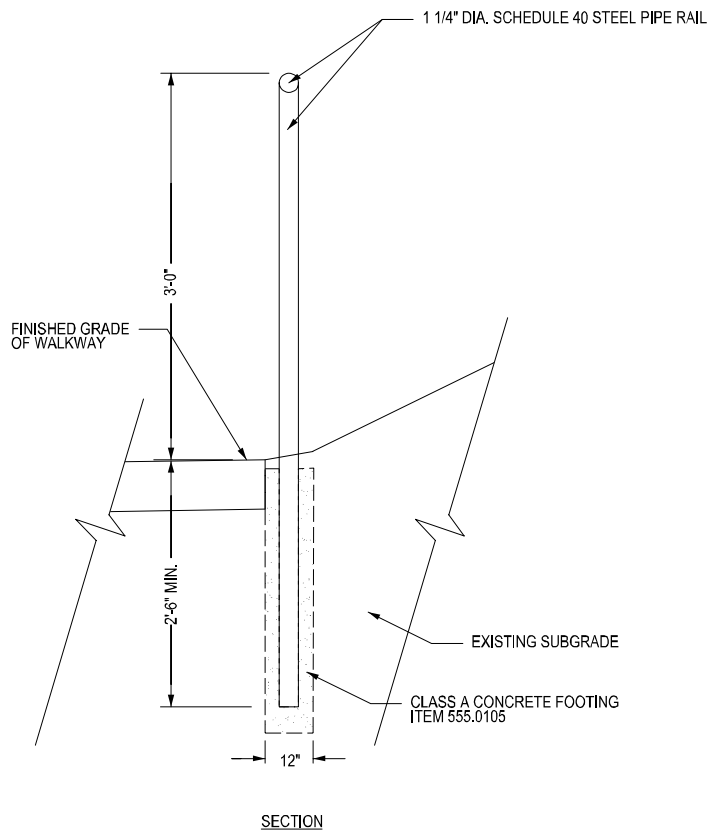

1 PIPE RAILING DETAIL - ITEM 568.80  
MD-4 NOT TO SCALE

**Barton  
& Loguidice**

UNAUTHORIZED ALTERATION OR ADDITION TO THIS  
DRAWING IS A VIOLATION OF THE NEW YORK STATE  
EDUCATION LAW ARTICLE 145 SECTION 7209

FOREST HOME WALKWAY IMPROVEMENTS  
FINAL DESIGN

TOWN OF ITHACA

TOMPKINS COUNTY

## MISCELLANEOUS DETAILS

SCALE: AS SHOWN

DATE ISSUED: 04/2021

DRAWING  
MD-4